

PC EXHIBIT C

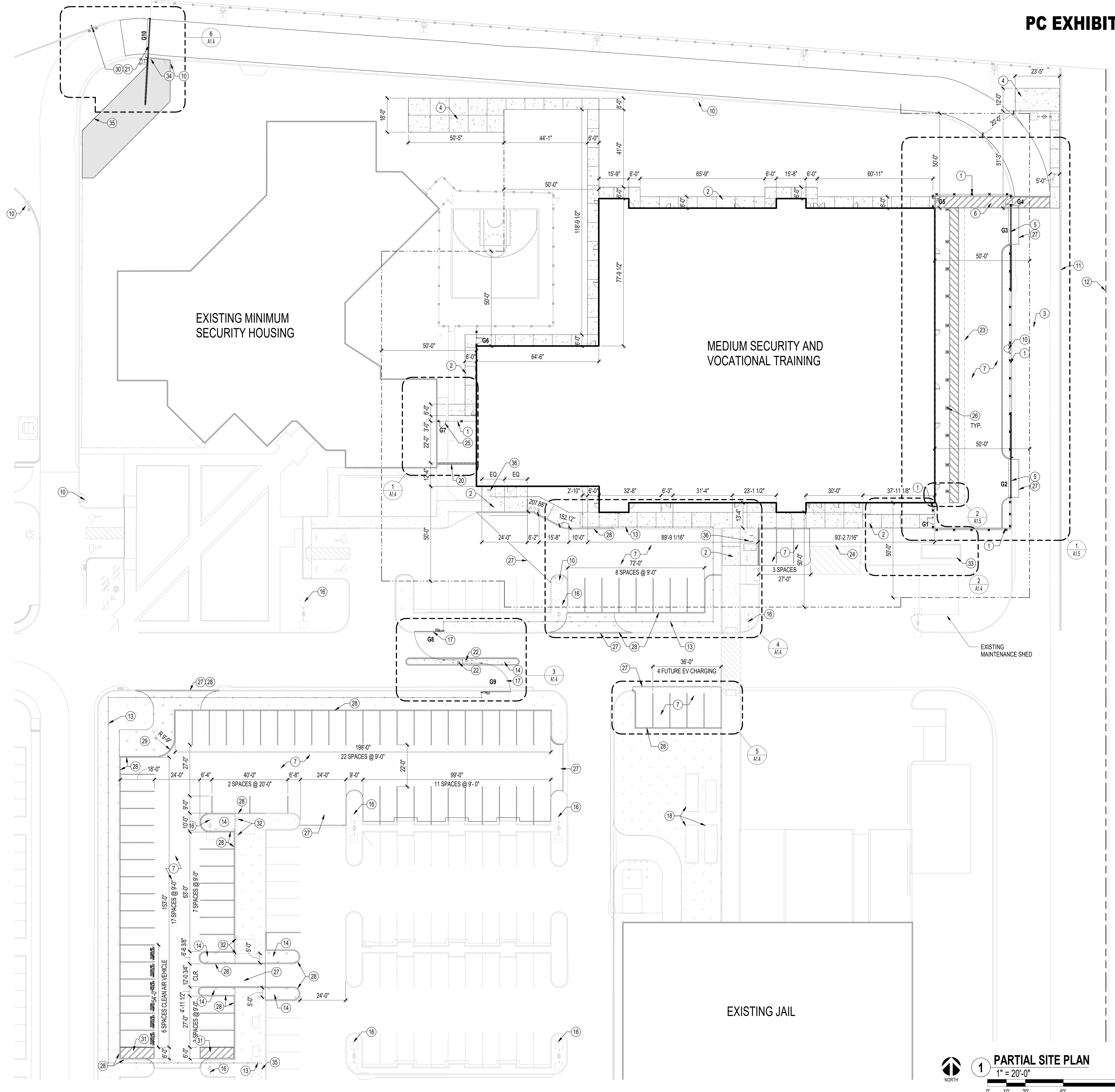

REFERENCE NOTES - SITE

NOTE: SITE PLAN KEYNOTES LISTED BELOW ARE TYPICAL TO THE SITE AND MAY NOT BE APPLICABLE AND/OR REFERENCED ON ALL SHEETS.

TYPE	DESCRIPTION
1	10' (H) NO CLIMB SECURITY FENCE TO MATCH EXISTING - SEE DETAIL 119/A9.1.1
2	NEW CONCRETE SIDEWALK
3	EXISTING FIRE ACCESS LANE
4	AREA OF SAFE DISPERSAL
5	20' (W) MANUAL ROLLING GATE - SEE DETAIL 16/A1.6
6	NEW WALKWAY STRIPING
7	NEW ASPHALT PAVING
8	EXISTING HVAC UNIT
9	NEW VEHICLE TURN OUT
10	EXISTING FIRE HYDRANT TO REMAIN
11	EXISTING PERIMETER 12' (H) CMU WALL
12	PROPERTY LINE
13	NEW ARCHITECTURAL FENCE TO MATCH EXISTING - SEE DETAIL 116/A9.1.1
14	CONSTRUCT NEW MEDIAN
15	EXISTING UTILITY COMPANY PAD MOUNT SWITCH
16	EXISTING LIGHT POLE
17	AUTOMATED SWINGING VEHICLE GATE - SEE DETAIL 14/A1.6
18	EXISTING GENERATOR
20	12' (H) CMU WALL - SEE DETAIL 102/A9.1.1
21	AUTOMATED SLIDING VEHICLE GATE - SEE DETAIL 15/A1.6
22	CONTROL COLUMN WITH CARD READER AND INTERCOM - SEE DETAIL 104/A9.1.1
23	CANOPY ABOVE
24	EXISTING DUMPSTER ENCLOSURE
25	NEW 3'-0"(W) X 7'-0"(H) CHAINLINK MAN GATE - SEE DETAIL 117/A9.1.1
26	CANOPY COLUMNS ON CONCRETE BASE
27	NEW PAVEMENT CUT, SEE CIVIL
28	NEW 6" CURB PER COUNTY CAMPUS STANDARD
29	LANDSCAPE ISLAND
30	HIGH AND LOW PEDESTAL CARD READER, INTERCOM, AND KNOX BOX MOUNTED ON CONCRETE BOLLARD - SEE DETAIL 115/A9.1.1
31	MOTORCYCLE PARKING
32	EXISTING BOLLARD TO REMAIN
33	NEW EMERGENCY GENERATOR
34	KNOX BOX LOCATION - SEE DETAIL 105/A9.1.1
35	EXISTING FENCE TO REMAIN
36	BIKE RACK (SEE DETAIL 107/A9.1.1) / STORAGE

LEGEND:

--- PROPERTY LINE	✕ CHAINLINK FENCE
▭ BUILDING FOOTPRINT LINE	▭ ARCHITECTURAL FENCE
--- 50' BUILDING AREA OF REFUGE OFFSET LINE	○ FIRE HYDRANT
- - - IMAGINARY LINE BETWEEN BUILDINGS ON THE SAME LOT	□ LIGHTPOLE

LEGEND:

▭ CONCRETE	▭ LANDSCAPING
▭ ASPHALT	▭ AGGREGATE BASE
▭ DECOMPOSED GRANITE	

- ### SITE CODE NOTES
- ALL COVERED ENTRANCES TO BE FULLY SPRINKLED.
 - SEE CIVIL PLANS FOR ADDITIONAL INFORMATION INCLUDING A HOSE DRAG PLAN.
 - A CONSTRUCTION LOGISTICS PLAN WILL BE PERMITTED TO SHOW EQUIPMENT, MATERIAL LAYDOWN AND WASTE COLLECTION. PLAN PROVIDES UNOBSTRUCTED FIRE ACCESS DURING CONSTRUCTION. SEE CIVIL DRAWINGS FOR PROPERTY LINE BOUNDARY AND POST CONSTRUCTION FIRE DEPARTMENT ACCESS.
 - THERE ARE TO BE NO DEAD-END FIRE APPARATUS ACCESS ROADS IN EXCESS OF 150'-0" WITHOUT PROVIDING AN APPROVED TURN AROUND AREA.
 - PROVIDE SIGNS OR OTHER APPROVED NOTICES OR MARKINGS THAT INCLUDE THE WORDS "NO PARKING-FIRE LANE" AS REQUIRED BY THE FIRE CODE OFFICIAL.
 - ALL FIRE RISER ROOMS WILL HAVE KNOX BOX ACCESS.
 - BICYCLE STORAGE IS ALSO PROVIDED IN STAFF LOCKER ROOMS.

- ### APPLICABLE CODES
- THIS PROJECT IS DESIGNED TO COMPLY WITH THE FOLLOWING CODES:
- 2019 BUILDING STANDARDS ADMINISTRATIVE CODE, PART 1, TITLE 24 C.C.R.
 - 2019 CBC (CALIFORNIA BUILDING CODE), PART 2, TITLE 24 C.C.R.
 - 2018 INTERNATIONAL BUILDING CODE AND 2019 CALIFORNIA AMENDMENTS
 - 2019 CEC (CALIFORNIA ELECTRICAL CODE), PART 3, TITLE 24 C.C.R.
 - (2017 NATIONAL ELECTRICAL CODE AND 2019 CALIFORNIA AMENDMENTS)
 - 2019 CPC (CALIFORNIA PLUMBING CODE), PART 5, TITLE 24 C.C.R.
 - (2018 UNIFORM PLUMBING CODE AND 2019 CALIFORNIA AMENDMENTS)
 - 2019 CEC (CALIFORNIA ENERGY CODE), PART 6, TITLE 24 C.C.R.
 - 2019 CPC (CALIFORNIA FIRE CODE), PART 9, TITLE 24 C.C.R.
 - (2018 INTERNATIONAL FIRE CODE AND 2019 CALIFORNIA AMENDMENTS)
 - 2019 CBCSC (CALIFORNIA GREEN BUILDING STANDARDS CODE) (CAL GREEN), PART 11, TITLE 24 C.C.R.
 - 2019 CALIFORNIA REFERENCED STANDARDS, PART 12, TITLE 24 C.C.R.
 - TITLE 19 C.C.R., PUBLIC SAFETY, STATE FIRE MARSHAL REGULATIONS
 - NFPA 13 AUTOMATIC SPRINKLER SYSTEMS W/ CA AMENDMENTS 2016 EDITION
 - NFPA 14 STANDPIPE SYSTEMS W/ CA AMENDMENTS 2016 EDITION
 - NFPA 17A WET CHEMICAL SYSTEMS 2016 EDITION
 - NFPA 20 STATIONARY PUMPS 2016 EDITION
 - NFPA 24 PRIVATE FIRE MAINS W/ CA AMENDMENTS 2016 EDITION
 - NFPA 72 NATIONAL FIRE ALARM CODE W/ CA AMENDMENTS 2016 EDITION
 - NFPA 2001 CLEAN AGENT FIRE EXTINGUISHING SYSTEMS W/ CA AMENDMENTS 2015 EDITION
- REFERENCE CODE SECTION FOR NFPA STANDARDS ARE IN 2019 CBC CHAPTER 35 OR 2019 CPC CHAPTER 80. SEE CHAPTER 35 FOR STATE OF CALIFORNIA AMENDMENTS TO NFPA STANDARDS.

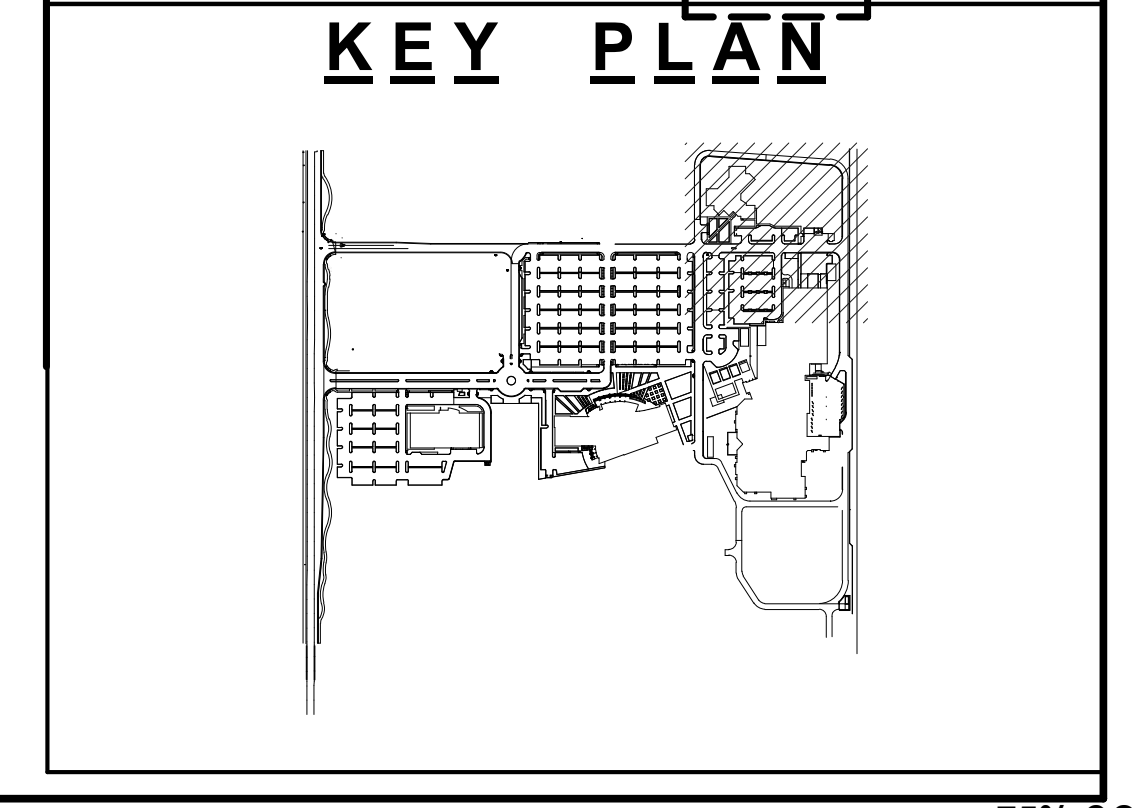

PRELIMINARY NOT FOR CONSTRUCTION

RESERVED FOR STATE FIRE MARSHAL



C/S BROWARD
builders



700 Alhambra Blvd.
Sacramento, California 95816
Main: (916) 234-3731
Fax: (902) 279-9110
© Copyright 2022

SB844
COUNTY OF PLACER
MEDIUM SECURITY & VOCATIONAL TRAINING
11751 GO FOR BROKE ROAD, ROSEVILLE, CA 95678
California State Fire Marshal Permit # 22-N-2760-CP-DR

NO.	REVISION	DATE

PROJECT NO.:	2022_042
DATE:	10/05/2022
DESIGNED BY:	PT
DRAWN BY:	AW
APPROVED BY:	LH
SHEET TITLE:	BUILDING A - MSVTF ARCHITECTURAL PARTIAL SITE PLAN
SHEET NUMBER:	3 OF 21

